

# Brass Ball Valve - Locking Lever

Nickel Plated Brass Body, Brass Ball Stem, PTFE Seats, Full Bore

**V2312 - Yellow ever Screwed BS**

**V2318 - Red ever Screwed BS**

**V231 - Red ever Screwed N**

Pressure / Temperature Specifications	
Pressure	PN40 ¼" to 1"
	PN25 1¼" to 2"
	PN16 2½" to 4"
Temperature	-20°C to 110°C

Material List	
Description	Material
Body	Brass
Bonnet	Brass
Ball	Brass
Stem	Brass
Seat	PTFE
Handle	Iron
Nut	Brass
O-Ring	NBR

Dimensions						
DN	Size	I	L	H	R	Kg
10	¼"	14	52	45	97	0.18
12	⅜"	16.5	52	48	96	0.17
15	½"	16	59	51	95	0.16
20	¾"	16	62	54	95	0.27
25	1"	18	71	66	111	0.41
32	1¼"	19	83	69	133	0.62
40	1½"	24	101	78	130	0.87
50	2"	20	104	99	200	1.5
65	2½"	33	152	125	245	2.03
80	3"	36	170	135	245	3.72
100	4"	41	205	145	245	5.98

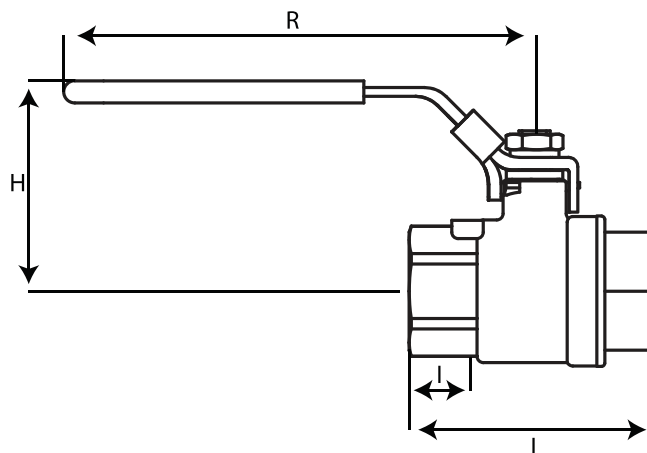

All information is sourced from our manufacturer's data and is intended for guidance only - Leengate Valves can accept no liability for changes, omissions or errors.